

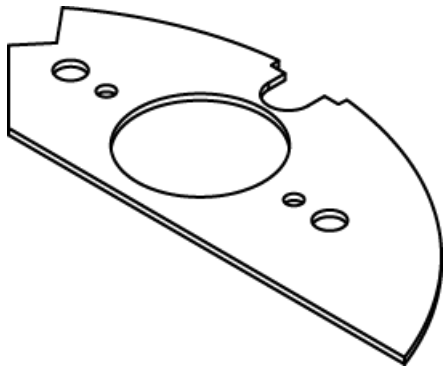

Wiremold
CRFB Series 1.60 (41mm) Device Plate
Part No. CRFB-SR2-2



The CRFB4 has four compartments that accept different device plates. This Device Plate is for Plate location 2, accepts most 20A and 30A turnlok receptacles. NOTE: When using a 30A device, egress opening must be located directly over receptacle. Standard size for device plates for Plate Location 2 is 5 7/32" (132mm) x 2 3/4" (62mm).

Features & Benefits

The CRFB4 has four compartments that accept different device plates. This Device Plate is for Plate location 2, accepts most 20A and 30A turnlok receptacles. NOTE: When using a 30A device, egress opening must be located directly over receptacle. Standard size for device plates for Plate Location 2 is 5 7/32" (132mm) x 2 3/4" (62mm).

Specifications

General Info

Product Line	Wiremold	UPC Number	786776138641
Country Of Origin	United States	Construction	Assembled
Application Sector	Commercial	Standard	UL Listed Classified Raised Floor Box: File E2961 Guide QCIT, UL Listed Classified Raised Floor Box (prewired): File E51105 Guide QQVX Meets Article 314 of NEC. Meets Article 12-2500 of CEC.
Type	Floor Box		

Listing Agencies / 3rd Party Agencies

cULus ListingNumber	E2961	cULus Listed	Yes
---------------------	-------	--------------	-----

Additional Information

RoHS Conformant	Yes
-----------------	-----